



PUBLIC

## Ashtrays

### 00.055

Wall mounted ashtray metallic



**00.055-00**

Inox Satin

---

---

---

---

---

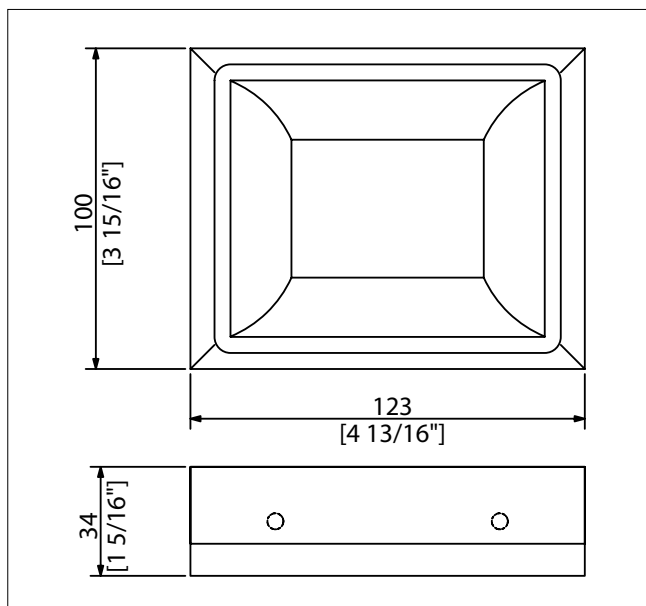

Wall mounted Ashtray is manufactured completely from AISI 304 stainless steel. Frame is 1.2mm thick and attaches to 1.2mm thick ashtray with stainless steel hinge. Frame securely attaches to wall with stainless steel screws. Ashtrays flips over for easy cleaning.



PUBLIC

## Paper Holders

### 00.112

Jumbo roll paper dispenser



**00.112-30**  
**CHRH670**

Inox Bright

**00.112-00**  
**CHRX670**

Inox Satin

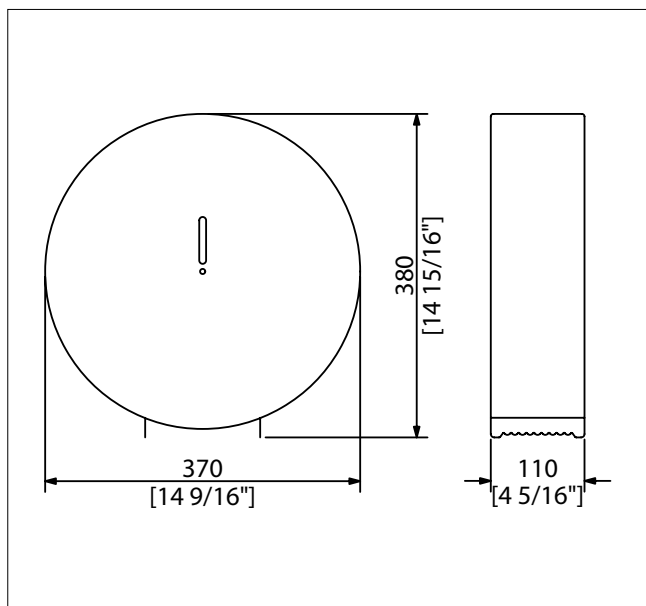

Jumbo Roll Paper Dispenser is completely manufactured from 0.8mm thick AISI 304 stainless steel. It securely attaches to wall with two stainless steel screws.



PUBLIC

## Waste Receptacles

**00.139**

Waste receptacle



**00.139-30**

Inox Bright

**00.139-00**

Inox Satin

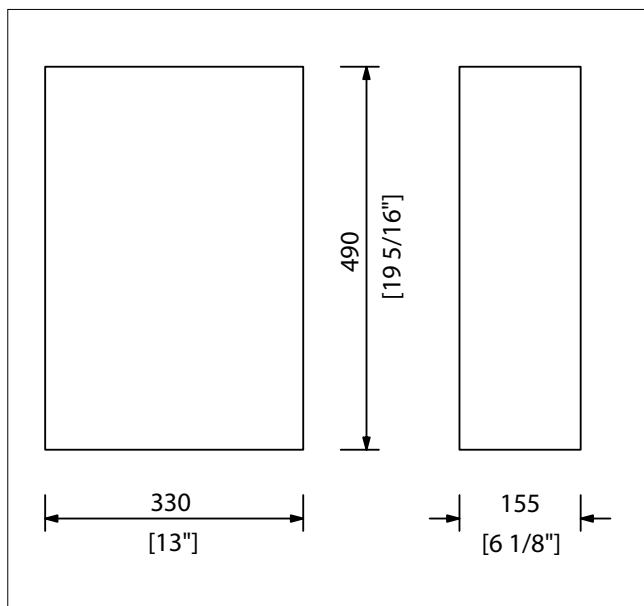

Waste Receptacle is completely manufactured from 0.8mm thick AISI 304 stainless steel. Capacity is 25lt. It securely attaches to wall with two stainless steel screws.



PUBLIC

## Paper Towel Dispensers

### 00.160

Recessed paper towel dispenser



**00.160-30**

Inox Bright

**00.160-00**

Inox Satin

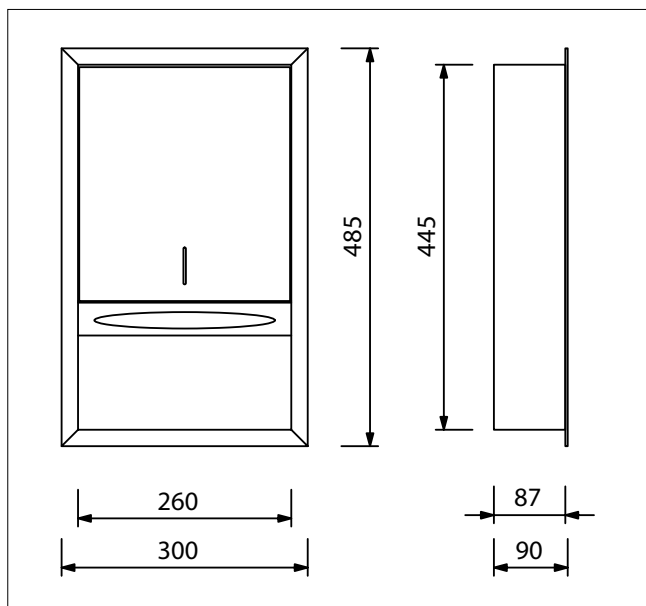

Recessed Paper Towel Dispenser is manufactured completely from 0.8mm thick AISI 304 stainless steel. Paper Towel Dispenser has a capacity of 300 C-fold paper towels. The cover attaches to cabinet with stainless steel pivot and locks with concealed stainless steel lock. The cover has a slot that indicates refill time. The required wall opening for recession is 265 mm x 455 mm with a depth of 90 mm.



PUBLIC

## Urinal Separators

**00.170**

Urinal separator

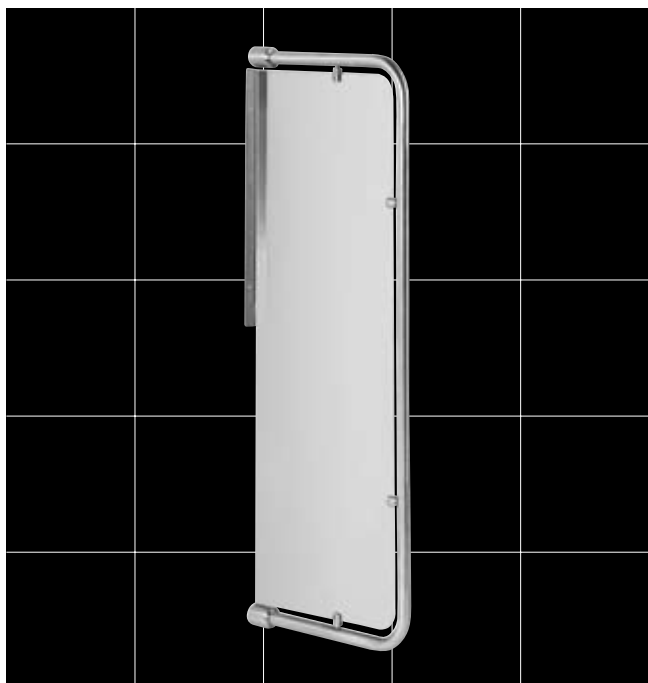

**00.170-00**

Inox Satin

---

---

---

---

---

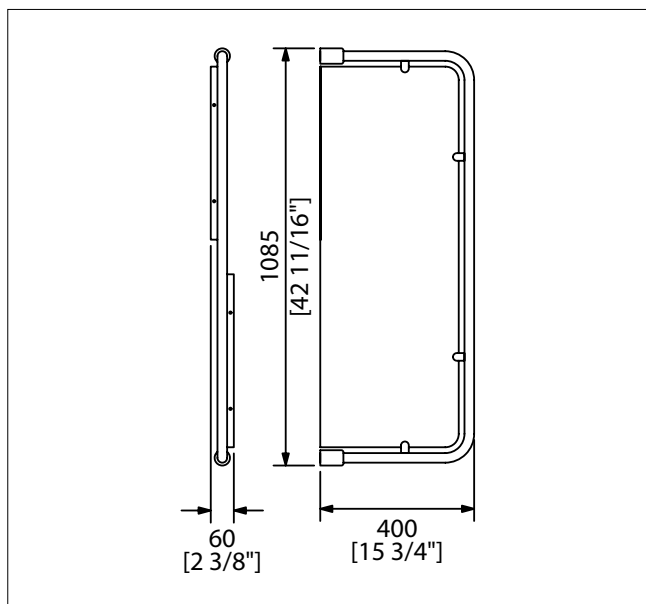

Urinal Separator is manufactured completely from AISI 304 stainless steel. Frame is 25mm tube, 1.5mm thick and is mechanically attached to solid stainless steel brackets. Panel is 2mm thick. Separator is securely attached to wall with four exposed stainless steel screws.



PUBLIC

## Paper Holders

**00.212**

Jumbo roll paper dispenser

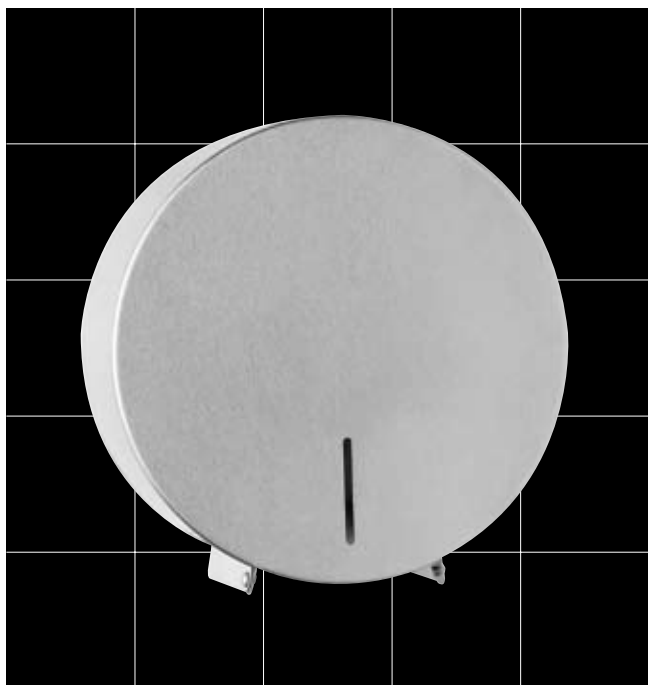

**00.212-30**

Inox Bright

**00.212-00**

Inox Satin

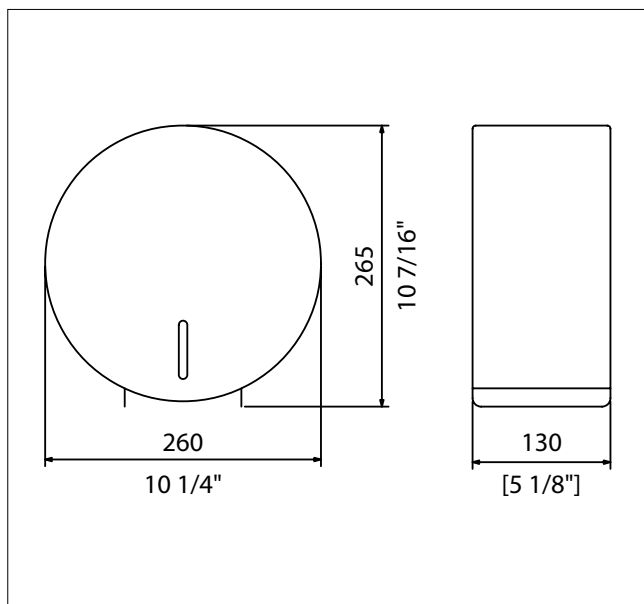

Jumbo Roll Paper Dispenser is completely manufactured from 0.8mm thick AISI 304 stainless steel. It securely attaches to wall with two stainless steel screws.



# PUBLIC

## Waste Receptacles

### 00.260

Recessed waste receptacle



**00.260-30**

Inox Bright

**00.260-00**

Inox Satin

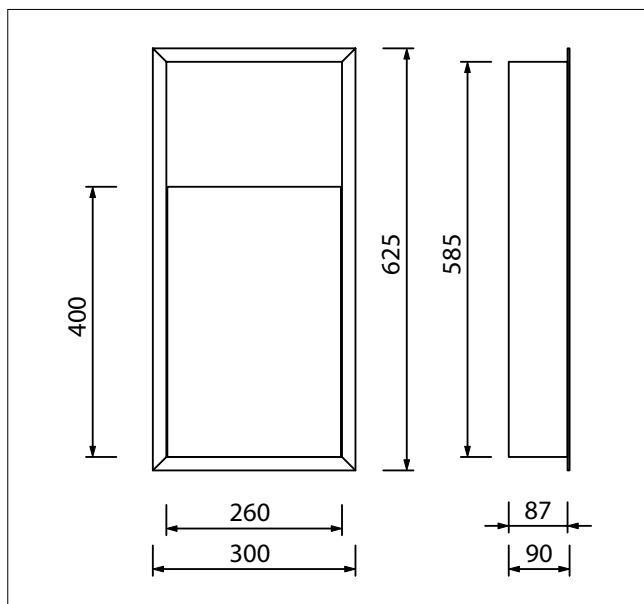

Recessed Waste Receptacle is manufactured completely from 0.8mm thick AISI 304 stainless steel. The Waste Receptacle is removable for easy cleaning. The required wall opening for recession is 265 mm x 605 mm with a depth of 90 mm.



PUBLIC

## Paper Towel Dispensers

**00.331**

Paper towel dispenser 300 pcs



**00.331-30**

Inox Bright

**00.331-00**

Inox Satin

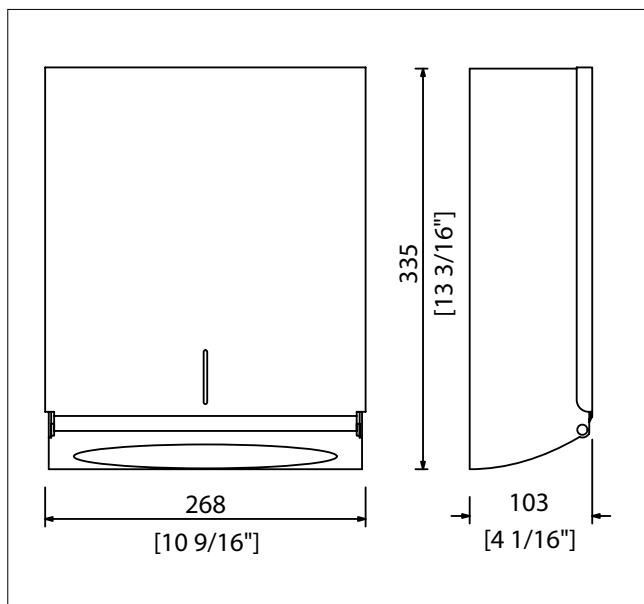

Paper Towel Dispenser is completely manufactured from 0.8mm thick AISI 304 stainless steel. Cover attaches to cabinet with stainless steel pivot and locks with concealed stainless steel lock. Cover has slot that indicates refill time. The capacity of the dispenser is 300 C-fold paper towels. It securely attaches to wall with three stainless steel screws.





PUBLIC

## Paper Towel Dispensers

### 00.360

Recessed paper towel dispenser and waste receptacle combination



**00.360-30**

Inox Bright

**00.360-00**

Inox Satin

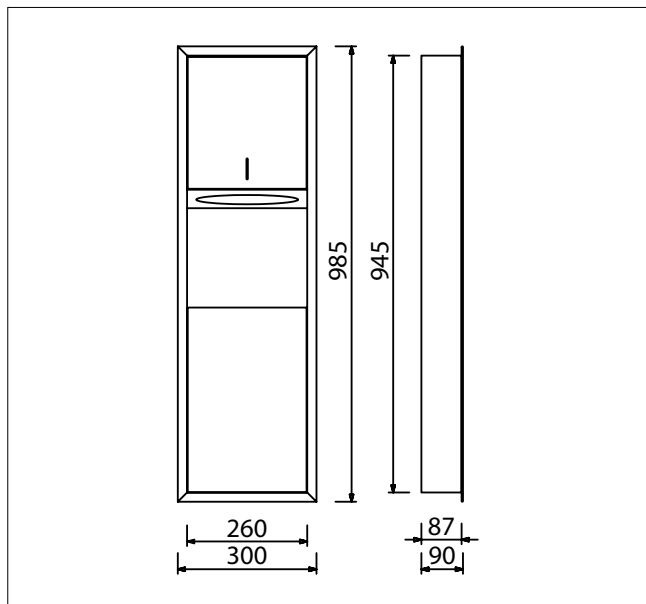

Recessed Paper Towel Dispenser and Waste Receptacle combination is manufactured completely from 0.8mm thick AISI 304 stainless steel. Paper Towel Dispenser has a capacity of 300 C-fold paper towels. The cover attaches to cabinet with stainless steel pivot and locks with concealed stainless steel lock. The cover has a slot that indicates refill time. The Waste Receptacle is removable for easy cleaning. The required wall opening for recession is 265 mm x 955 mm with a depth of 90 mm.



PUBLIC

## Waste Receptacles

### 00.460

Recessed waste receptacle with flap



**00.460-30**

Inox Bright

**00.460-00**

Inox Satin

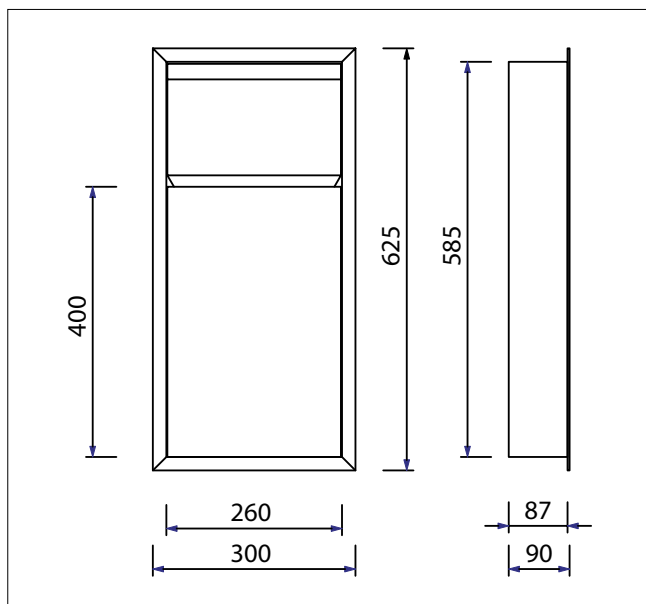

Recessed Waste Receptacle with lid is manufactured completely from 0.8mm thick AISI 304 stainless steel. The Waste Receptacle is removable for easy cleaning. The lid attaches to cabinet with stainless steel pivot. The required wall opening for recession is 265 mm x 605 mm with a depth of 90 mm.



PUBLIC

## Liquid Soap Dispensers

### 04.118

Liquid soap dispenser 500 ml



**04.118-01**

Bright

---

---

---

---

---

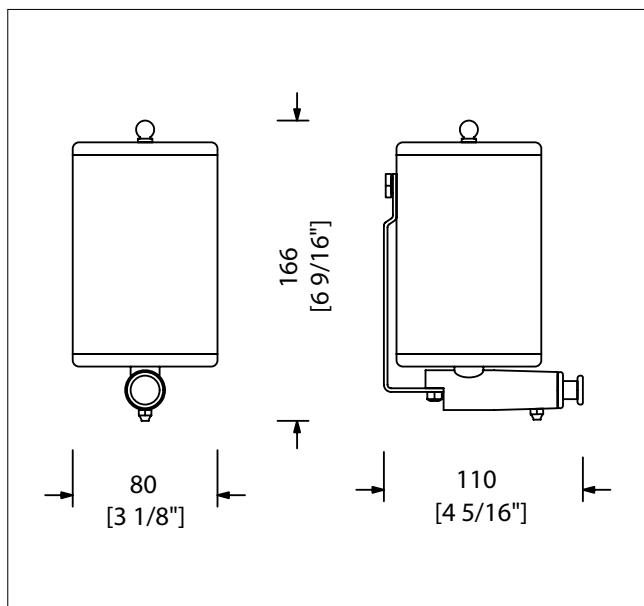

Liquid Soap Dispenser is manufactured from brass and AISI 304 stainless steel. Container is 1.5mm thick brass. Pump is solid brass and operates with stainless steel spring. Dispenser is mounted to wall with 1.2mm thick mounting flange and stainless steel screws.



PUBLIC

## Liquid Soap Dispensers

**04.518**

Liquid soap dispenser 1200 ml



**04.518-30**

Inox Bright

**04.518-00**

Inox Satin

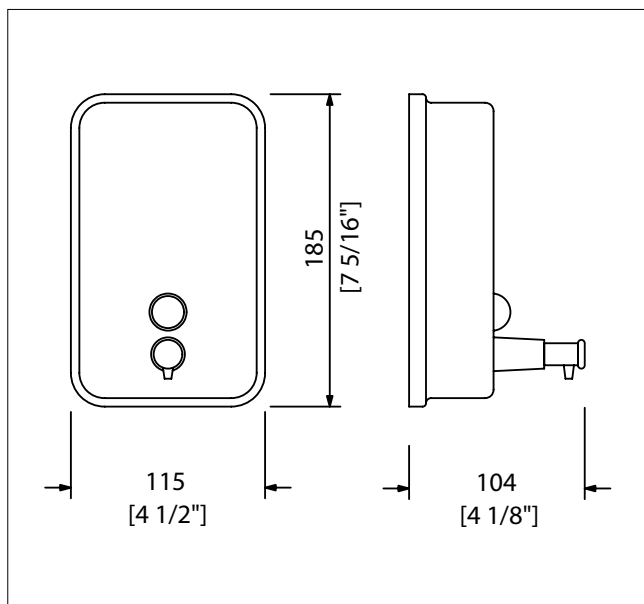

Liquid Soap Dispenser is manufactured from AISI 304 stainless steel. Container is 0.8mm thick and is equipped with a transparent refill indicator. The internal mechanism of the pump is manufactured from high quality plastic and operates with stainless steel spring. Dispenser is mounted to wall with 1.2mm thick mounting flange and stainless steel screws.



PUBLIC

## Liquid Soap Dispensers

### 30.118

Vanity liquid soap dispenser 500 ml

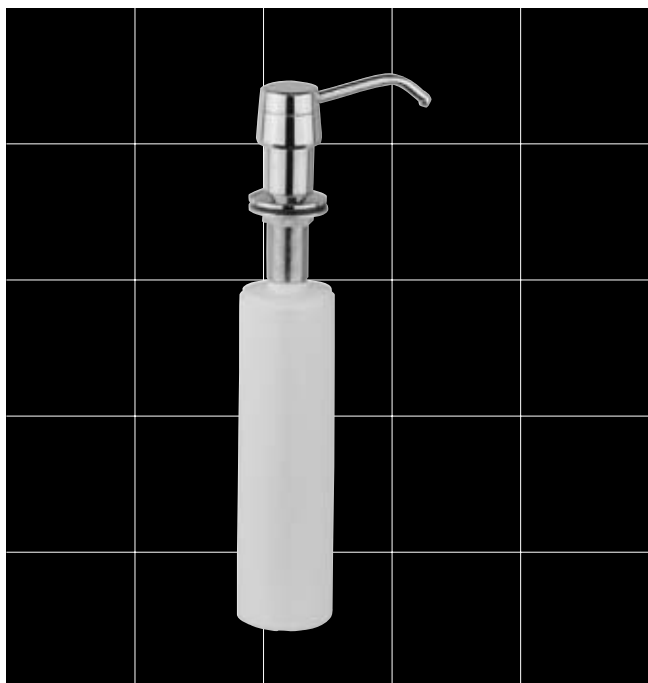

**30.118-30**

Inox Bright

---

---

---

---

---

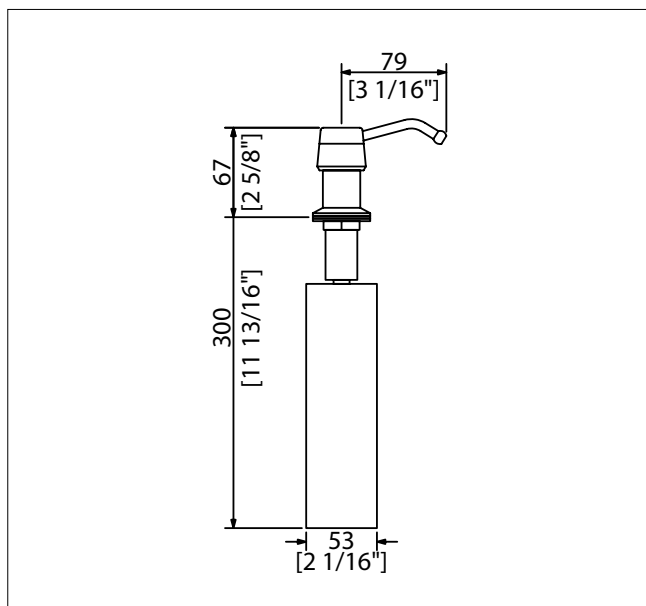

Vanity Liquid Soap Dispenser is manufactured from AISI 304 stainless steel and plastic. The pump is manufactured from stainless steel and the internal mechanism of the pump is manufactured from high quality plastic and operates with stainless steel spring. The container is manufactured from high quality plastic.



PUBLIC

## Liquid Soap Dispensers

### 30.318

Vanity liquid soap dispenser 1000 ml

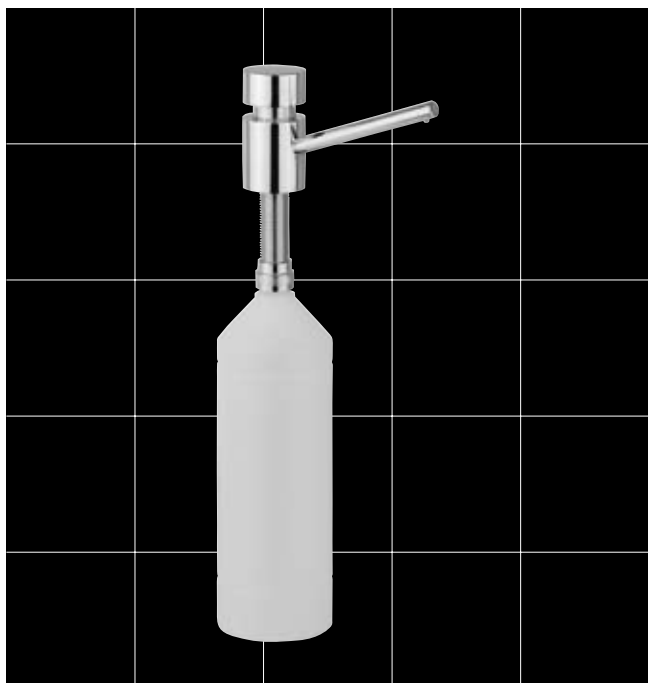

#### 30.318-01 SD80

---

---

---

---

---

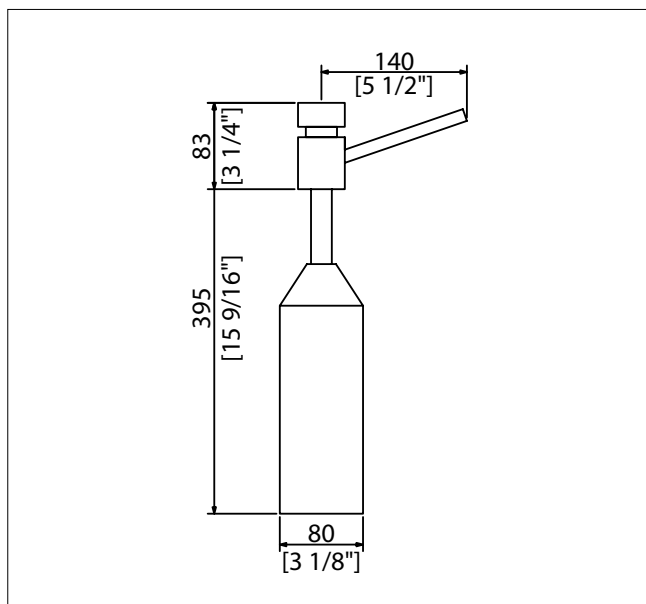

Liquid soap dispenser for table top mounting, into worktops with max. 45 mm thickness, high polished chromated brass, requires 22 mm drilling hole, 1/2 thread, spout not movable, spout length 140 mm, suitable for liquid soaps and lotions, 1 litre soap tank with membrane for pressure balance, filled from above.



PUBLIC

## Hand Dryers

### 52.022

Hand dryer with photocell 2200W



**52.022-00**

Inox Satin

**ARTH310**

**52.022-30**

Inox Bright

**ARTH310HP**

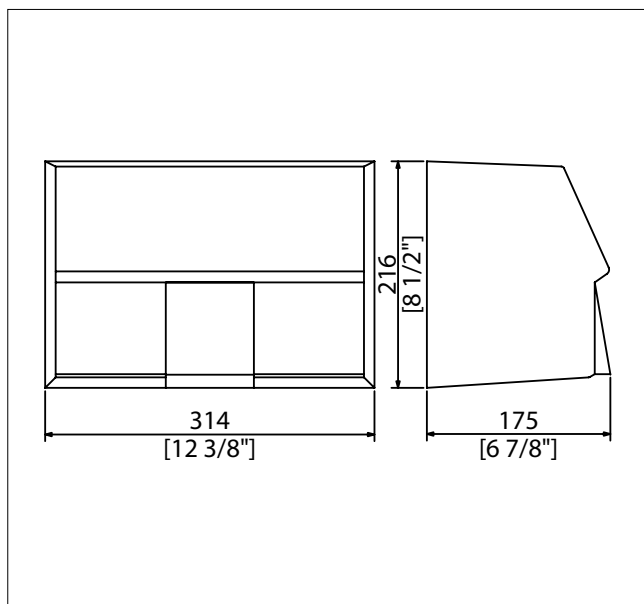

Hand Dryer with Photocell is manufactured from 1.2mm thick AISI 304 Stainless Steel. Operation is automatic due to an electronic sensor. Electrical Characteristics: Voltage: 220/240V Heating Element: 2100W Overall power absorption: 2200W Air flow: 4.6 m<sup>3</sup>/min Noise Level: 61-67 dBA