



SOLVENT CEMENT



CONTACT ADHESIVE & PVA/WHITE GLUE



SILICONE SEALANT



HP ADHESIVES PVT. LTD.

PRODUCT CATALOGUE



**Solvent
Cement**



**Silicone
Sealant**



**Contact
Adhesive**



**PVA / White
Glue**



**FRP Manhole
Cover**



ABOUT US

HP ADHESIVES PVT. LTD., the Flagship company of the HP Group, is proud to be the largest manufacturer of Solvent Cement in Asia. With an annual turnover of over 25 Million USD in only solvent cement and a group turnover of more than 40 Million USD, the HP Group has come a long way for various business streams since its inception in 1978 by the Motwani family. Its interests range from Adhesives, Composite Products, Plumbing Accessories, Textiles, Logistics & Real Estate.

Thanks to our constant vision and leadership, the solvent cement business has always been the pride of the group. It is also the flagship venture of the HP Group and has evolved ever since its inception. The HP Group was founded on the principles of trust and reliability and has always put its stakeholders (employees, customers) first. It has envisioned the creation of an agile, customer-friendly organization that has always given the market par plus product and services. All the business combined, the group is a well-oiled machine with the right mix of talent, technology, capital, and resources, bringing in international expertise to make its product, process, and offering them at par with global standards.

Growth through diversification has been the cornerstone of the success of the HP Group and all its companies. A steady yearly increase in sales, profits, and satisfied customer base has ensured that we haven't looked back – going from strength to strength through our 40 years journey. In this time, the HP Group has achieved many successful milestones, the most recent being its recognition as "the leader of tomorrow" in the chemical space by ET Now – the leading business channel in India. This is attributed to the company's belief that these successes are only the beginning and many more goals await us. It is this fire that will drive the HP Group to the next level of success, along with a target to achieve the USD 100 Million Revenue mark by 2025.



INTERNATIONAL NETWORK

HP ADHESIVES PVT. LTD. solvent cements have always been well accepted due to their superior quality and consistency and a wide product range to choose from.



International collaboration with various companies in USA & Europe have helped the company bring its products to compete on any international stage, against the best products in the world. HP ADHESIVES PVT. LTD. has always emphasized that the quality of the product will outweigh all other parameters and therefore is rigorously committed towards its efforts to ensure the same. Its global presence in 52 countries has helped it understand the needs of maintaining different standards like (ASTM, NSF, DIN, BS & ISO etc.) It also understands its customer's needs and thus provides a diverse range of product. Its highest level of quality control and rigorous testing has always ensured consistency in all its products offering in the markets.

- Currently, HP ADHESIVES PVT. LTD. exports its range of products across 52 countries to 56 international customers i.e. 22 distributors and 34 OEMs
- Setting up a manufacturing unit in USA for penetrating the American market and further catering to the key customers in South East Asia, Central America, South America & Parts of Europe
- Backward integration of packing materials for international plants leading to margin improvement and better pricing capability
- Creating stocking locations globally to improve supply chain
- Expanding manpower globally, as per requirement for better customer services
- Adding key OEM customers in the current & new markets
- Creating efficient distribution channels for all the above markets



THE HP ADVANTAGE



Innovation

Our dedicated research & development team are at par with global standards and are constantly powered with a drive to venture into newer capabilities. This has helped us launch over 25 unique products under the HP ADHESIVES PVT. LTD banner.



Distribution

Strong distributions network has always been the cornerstone of success for HP ADHESIVES PVT. LTD. Having over 45 stock points in India and internationally, through partnership of ownership, HP ADHESIVES PVT. LTD. has been able to efficiently reach out and serve our customers better.



Quality Control

HP ADHESIVES PVT. LTD. follows a strict system of inward testing of all raw materials with a specific quality control guidance for each. This includes quality control for chemicals, density for P.T.F.E rolls, Bust strength testing for ball valves, Pressure testing for plugs, etc. These stringent QC norms ensures the reliability and consistency of our products.



Quality Objectives

Consistency in quality is the main focus for every product at HP ADHESIVES PVT. LTD. We follow strict quality policies with following objectives:

- To maintain customer complaints at less than 1% per year
- To increase customer feedback by 15% every year
- To plan quality related training programs, every 2 months
- To conduct customer surveys every 2 months
- To implement any need for improvement or upgrade on top priority



Hydrostatic Burst Strength



Tensile Testing



Visco Meter



GCMS



300 for PVC / Regular Bodied

- ▲ PVC cement for all classes and schedules with interference fit through 4" (110mm) diameter except schedule 80
- ▲ Recommended for all grades and types of PVC pipe & fitting
- ▲ Excellent for irrigation, electrical conduit, pool & spa, plumbing including PVC foam core pipes

Body	Regular
Set Time	Fast
Color	Clear
Maximum Pipe Size (interference fit)	4" PVC All rigid PVC Not for schedule 80

Industrial Listing & Performance Specs ASTM D 2564



Available in size:

118ml (04 OZ) Tin, 237ml (08 OZ) Tin, 473ml (16 OZ) Tin, 946ml (32 OZ) Tin & 5000ml (1.32 GL)



302 for PVC / Regular Bodied

- ▲ PVC cement for all classes and schedules with interference fit through 4" (110 mm) diameter except Schedule 80
- ▲ Excellent for DWV, irrigation, electrical conduit, pool & spa, plumbing including PVC foam core pipe

Body	Regular
Set Time	Fast
Color	Clear
Maximum Pipe Size (interference fit)	4" PVC All rigid PVC Not for schedule 80

Industrial Listing & Performance Specs ASTM D 2564



Available in size:

118ml (04 OZ) Tin, 237ml (08 OZ) Tin, 473ml (16 OZ) Tin, 946ml (32 OZ) Tin & 5000ml (1.32 GL)



304 for PVC / Medium Bodied

- ▲ PVC cement for all classes and schedules with interference fit through 6" (160 mm) diameter, Schedule 80 through 4" (110 mm) diameter
- ▲ Quality formulation for irrigation, electrical conduit, pool & spa & plumbing
- ▲ Can be used without primer on non-pressure systems if local codes permit

Body	Medium
Set Time	Fast
Color	Clear / Gray
Maximum Pipe Size (interference fit)	6" PVC 4" schedule 80

Industrial Listing & Performance Specs ASTM D 2564



Available in size:

118ml (04 OZ) Tin, 237ml (08 OZ) Tin, 473ml (16 OZ) Tin, 946ml (32 OZ) Tin & 5000ml (1.32 GL)



305 for PVC / Medium Bodied

- ▲ PVC cement for all classes and schedules with interference fit through 6" (160mm) diameter schedule 80 through 4" (110 mm) diameter
- ▲ Quality product for industrial, irrigation, DWV, electrical conduit, pool & spa, plumbing including PVC foam core pipe
- ▲ Suitable for use as a one step cement without primer on non-pressure systems if local codes permit

Body	Medium
Set Time	Fast
Color	Clear/Blue/Gray
Maximum Pipe Size (interference fit)	6" PVC 4" schedule 80

Industrial Listing & Performance Specs ASTM D 2564



Available in size:

118ml (04 OZ) Tin, 237ml (08 OZ) Tin, 473ml (16 OZ) Tin, 946ml (32 OZ) Tin & 5000ml (1.32 GL)



311 for PVC / Heavy Bodied

- ▲ PVC cement for all classes and schedules with interference fit, including Schedule 80 through 12" (315 mm) diameter
- ▲ It has good gap filling properties and its medium set allows more working time in warm weather
- ▲ High-strength formula is ideal for industrial piping systems

Body	Heavy
Set Time	Medium
Color	Clear/Gray
Maximum Pipe Size (interference fit)	For all classes & sch. with interference fit through 12"

Industrial Listing & Performance Specs ASTM D 2564



Available in size:

118ml (04 OZ) Tin, 237ml (08 OZ) Tin, 473ml (16 OZ) Tin, 946ml (32 OZ) Tin & 5000ml (1.32 GL)



317 for PVC / Heavy Bodied

- ▲ PVC cement for all classes and schedules with interference fit through 12" (315 mm) diameter (non-pressure applications only up to 18")
- ▲ Quality formulation for plumbing, industrial, pool, irrigation and electrical piping systems
- ▲ It has good gap filling properties and its medium set allows more working time in warm weather

Body	Heavy
Set Time	Medium
Color	Clear / Gray
Maximum Pipe Size (interference fit)	For all classes & sch. with interference fit through 12"

Industrial Listing & Performance Specs ASTM D 2564



Available in size:

118ml (04 OZ) Tin, 237ml (08 OZ) Tin, 473ml (16 OZ) Tin, 946ml (32 OZ) Tin & 5000ml (1.32 GL)



319 for PVC / Extra Heavy Bodied

- ▲ PVC cement for all classes and schedules with interference fit, including Schedule 80 through 30" (800 mm) diameter
- ▲ Premium, high-strength formulation for large size industrial piping systems. Ideal for fabrication of large fittings and applications requiring high gap filling properties. It is suitable for irrigation, conduit, other pressure and non-pressure applications

Body	Extra Heavy
Set Time	Slow
Color	Clear/Gray/White
Maximum Pipe Size (interference fit)	For all classes & sch. with interference fit through 30"

Industrial Listing & Performance Specs ASTM D 2564



Available in size:

118ml (04 OZ) Tin, 237ml (08 OZ) Tin, 473ml (16 OZ) Tin, 946ml (32 OZ) Tin & 5000ml (1.32 GL)



ALL PRESSURE / Extra Heavy Bodied

- ▲ PVC cement for all classes and schedules with interference fit, including Schedule 80 through 18" (450 mm) diameter
- ▲ Premium, high-strength formulation for large size industrial piping systems.
- ▲ Ideal for fabrication of large fittings and applications requiring high gap filling properties
- ▲ Also suitable for irrigation, conduit, other pressure and non-pressure applications

Body	Thixotropic
Set Time	Slow
Color	Clear
Maximum Pipe Size (interference fit)	For all classes & sch. with interference fit through 18"

Industrial Listing & Performance Specs ASTM D 2564



Available in size:

118ml (04 OZ) Tin, 237ml (08 OZ) Tin, 473ml (16 OZ) Tin, 946ml (32 OZ) Tin & 5000ml (1.32 GL)



313 for CPVC / Regular Bodied

- ▲ CPVC cement for copper tube size and schedule 40 pipe and fittings with interference fit through 2" (63 mm) diameter
- ▲ Residential and commercial hot and cold water systems up to 180°F/82°C
- ▲ Recommended application temperature 0°F to 115°F / -17°C to 46°C
- ▲ Used for Corzan type CPVC piping systems

Body	Regular
Set Time	Fast
Color	Orange
Maximum Pipe Size (interference fit)	CPVC pipe sizes through 2"

Industrial Listing & Performance Specs ASTM F 493
ASTM D 2846



Available in size:

118ml (04 OZ) Tin, 237ml (08 OZ) Tin, 473ml (16 OZ) Tin, 946ml (32 OZ) Tin & 5000ml (1.32 GL)



314 for CPVC / Heavy Bodied

- ▲ CPVC cement for all classes and schedules with interference fit through 12" (315 mm) diameter
- ▲ Industrial quality for non-chemical applications up to 180°F (82°C). Approved for use on CPVC piping systems
- ▲ Recommended application temperature 0°F to 115°F / -17°C to 46°C

Body	Heavy
Set Time	Medium
Color	Orange/Gray
Maximum Pipe Size (interference fit)	For all classes & sch. with interference fit through 12"

Industrial Listing & Performance Specs ASTM F 493
ASTM D 2846



Available in size:

118ml (04 OZ) Tin, 237ml (08 OZ) Tin, 473ml (16 OZ) Tin, 946ml (32 OZ) Tin & 5000ml (1.32 GL)



324 for CPVC / Heavy Bodied

- ▲ CPVC cement for all classes and schedules with interference fit through 12" (315 mm) diameter
- ▲ Premium, high-strength, chemical-resistant solvent cement for use with CPVC piping systems carrying acids, bases, salts, and hypochlorite
- ▲ Recommended application temperature 40°F to 110°F / 4°C to 43°C
- ▲ Approved for corzan CPVC piping systems

Body	Heavy
Set Time	Medium
Color	Orange/Gray
Maximum Pipe Size (interference fit)	For all classes & sch. with interference fit through 12"

Industrial Listing & Performance Specs ASTM F 493
ASTM D 2846



Available in size:

118ml (04 OZ) Tin, 237ml (08 OZ) Tin, 473ml (16 OZ) Tin, 946ml (32 OZ) Tin & 5000ml (1.32 GL)



Gold for CPVC / Medium Bodied

- ▲ 1 Step Gold CPVC solvent cement for CTS 11 & 13.5 and ASTM sch. 40 & 80 upto 4" dia.
- ▲ ONE STEP CEMENT – formulated to be used without primer if Codes permit
- ▲ For potable water to 180°F (82°C). Suitable for residential plumbing and industrial systems
- ▲ Recommended application temperature 0°F to 115°F / -17°C to 46°C

Body	Medium
Set Time	Fast
Color	Yellow
Maximum Pipe Size (interference fit)	CPVC pipe sizes through 4"

Industrial Listing & Performance Specs ASTM F 493



Available in size:

118ml (04 OZ) Tin, 237ml (08 OZ) Tin, 473ml (16 OZ) Tin, 946ml (32 OZ) Tin & 5000ml (1.32 GL)



227 for ELECTRICAL / Medium Bodied

- ▲ Fast setting Cement for all PVC electrical conduit or any non-pressure PVC application with interference fit through 8" (200 mm) diameter
- ▲ High strength joints can be made at temperatures as low as -15°F and as high as 110°F
- ▲ Can be used without primer if local codes permit

Body	Medium
Set Time	Fast
Color	Clear
Maximum Pipe Size (interference fit)	For all classes & sch. with interference fit through 8"

Industrial Listing & Performance Specs ASTM D 2564



Available in size:

118ml (04 OZ) Tin, 237ml (08 OZ) Tin, 473ml (16 OZ) Tin, 946ml (32 OZ) Tin & 5000ml (1.32 GL)



325 for WET N DRY / Medium Bodied

- ▲ Fast setting PVC cement for all classes and schedules with interference fit through 6" (160 mm) diameter, schedule 80 through 4" (110 mm) diameter
- ▲ Premium formula for wet conditions and/or quick pressurization. Suitable for irrigation, plumbing, pool & spa applications
- ▲ Recommended application temperature 40°F to 110°F / 4°C to 43°C

Body	Medium
Set Time	Extreme fast
Color	Aqua Blue
Maximum Pipe Size (interference fit)	6" PVC 4" schedule 80

Industrial Listing & Performance Specs ASTM D 2564



Available in size:

118ml (04 OZ) Tin, 237ml (08 OZ) Tin, 473ml (16 OZ) Tin, 946ml (32 OZ) Tin & 5000ml (1.32 GL)



327 for HOT N COLD / Medium Bodied

- ▲ Fast setting PVC cement for all classes and schedules with interference fit through 6" (160 mm) diameter, schedule 80 through 4" (110 mm) diameter
- ▲ Premium formula for all weather conditions (-15°F to 110°F / -26°C to 43°C)
- ▲ Excellent for industrial, irrigation, electrical conduit, pool & spa, plumbing including PVC foam core pipe
- ▲ Can be used without primer on non-pressure systems if local codes permit

Body	Medium
Set Time	Very fast
Color	Clear
Maximum Pipe Size (interference fit)	6" PVC 4" schedule 80

Industrial Listing & Performance Specs ASTM D 2564



Available in size:

118ml (04 OZ) Tin, 237ml (08 OZ) Tin, 473ml (16 OZ) Tin, 946ml (32 OZ) Tin & 5000ml (1.32 GL)



335 for WET N FAST / Medium Bodied

- ▲ Fast setting PVC cement for all classes and schedules with interference fit through 6" (160 mm) diameter, schedule 80 through 4" (110 mm) diameter
- ▲ Plumbing quality cement for wet conditions and/or quick pressurization
- ▲ Can be used without primer on non-pressure systems if local codes permit

Body	Medium
Set Time	Extreme fast
Color	Blue
Maximum Pipe Size (interference fit)	6" PVC 4" schedule 80

Industrial Listing & Performance Specs ASTM D 2564



Available in size:

118ml (04 OZ) Tin, 237ml (08 OZ) Tin, 473ml (16 OZ) Tin, 946ml (32 OZ) Tin & 5000ml (1.32 GL)



350 for HOTWELD / Medium Bodied

- ▲ Fast setting PVC solvent cement. It is suitable for use on rigid PVC with interference fit sch. 40 thru 6" (160 mm) and sch. 80 thru 4" (110 mm)
- ▲ Premium, hot blue formulation for irrigation, DWV, pool & spa, plumbing and non-pressure application
- ▲ Recommended application temperature 0°F to 115°F / -17°C to 46°C

Body	Medium
Set Time	Fast
Color	Blue
Maximum Pipe Size (interference fit)	6" PVC 4" schedule 80

Industrial Listing & Performance Specs ASTM D 2564



Available in size:

118ml (04 OZ) Tin, 237ml (08 OZ) Tin, 473ml (16 OZ) Tin, 946ml (32 OZ) Tin & 5000ml (1.32 GL)



378 for ABS / Medium Bodied

- ▲ Fast setting, ABS cement for all classes and schedules with interference fit through 8" (200 mm) diameter
- ▲ For plumbing application (DWV, sewer, & drain pipe), conduit and foam core

Body	Medium
Set Time	Fast
Color	Clear/Black/Yellow
Maximum Pipe Size (interference fit)	For all classes & sch. with interference fit through 8"

Industrial Listing & Performance Specs ASTM D 2235



Available in size:

118ml (04 OZ) Tin, 237ml (08 OZ) Tin, 473ml (16 OZ) Tin, 946ml (32 OZ) Tin & 5000ml (1.32 GL)



394 for ABS-PVC / Medium Bodied

- ▲ Fast setting, transition cement for all classes and schedules with interference fit through 6" (160 mm) diameter (not for schedule 80)
- ▲ Specifically designed for use on PVC to ABS transition joints in non-pressure systems
- ▲ Suitable for sewer, DWV, and conduit

Body	Medium
Set Time	Fast
Color	Green
Maximum Pipe Size (interference fit)	For all classes & sch. with interference fit through 6"

Industrial Listing & Performance Specs ASTM D 2564



Available in size:

118ml (04 OZ) Tin, 237ml (08 OZ) Tin, 473ml (16 OZ) Tin, 946ml (32 OZ) Tin & 5000ml (1.32 GL)



P-48 for PRIMER / Non Bodied

- ▲ Very aggressive primer for use on PVC and CPVC pipe and fittings
- ▲ Recommended for commercial and large diameter thermoplastic piping systems, specifically CPVC schedule 40/80. Ideal for use in cold weather applications
- ▲ Removes surface dirt, grease and grime as well as softens the pipe surface to allow a fast, secure solvent weld

Body	Non-bodied
Set Time	Fast
Color	Clear/Purple
Maximum Pipe Size (interference fit)	All PVC/CPVC pipe size

Industrial Listing & Performance Specs ASTM F 656



Available in size:

118ml (04 OZ) Tin, 237ml (08 OZ) Tin, 473ml (16 OZ) Tin, 946ml (32 OZ) Tin & 5000ml (1.32 GL)

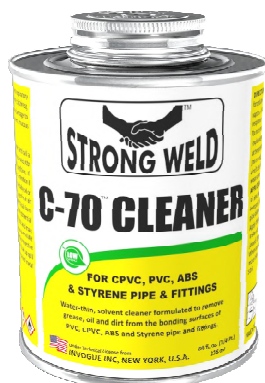

C-70 for CLEANER

- ▲ Specially formulated for removal of oil and grease from the surfaces of PVC, CPVC, ABS and STYRENE pipe and fittings
- ▲ Recommended for use before priming of pipe and fittings

Color	Clear
Maximum Pipe Size (interference fit)	No maximum All PVC/CPVC/ABS Styrene



Available in size:

118ml (04 OZ) Tin, 237ml (08 OZ) Tin, 473ml (16 OZ) Tin, 946ml (32 OZ) Tin

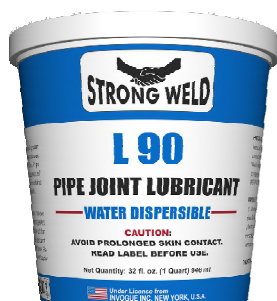

L-90 for LUBRICANT

- ▲ Custom-formulated, multipurpose lubricants are great for motors, circulators and other pumps, sliding parts, bearings, chains, linkage, or wherever metal lubrication is desired
- ▲ Non-toxic, soft, paste like material for lubricating bell joint pipe gaskets
- ▲ Will not deteriorate natural or synthetic rubber
- ▲ Will not support bacteria
- ▲ Dissolves in hot water

Available in size:

946ml (32 OZ) Tub

ESTIMATED USAGE CHART			
PIPE SIZE	LBS. PER 100 JOINTS	PIPE SIZE	LBS. PER 100 JOINTS
4"	3	30"	22
6"	4	36"	28
8"	5	42"	32
10"	6	48"	40
12"	9	54"	45
15"	11	60"	54
18"	13	66"	60
21"	16	72"	67
24"	17	78"	70
27"	19	84"	77



GASKET SHELLAC

Gasket shellac compound is a hard setting, slow drying liquid designed to coat, seal and repair most gaskets including felt, paper, rubber and composition type gaskets. It seals metal gaskets and threaded connections for light duty service. Gasket shellac is a dark brown, viscous liquid with a characteristic alcoholic odor.

PRODUCT BENEFITS

- ▲ Flexible when dry
- ▲ Good fuel resistance
- ▲ Improves reliability
- ▲ Saves time and labor
- ▲ Increases sealing reliability
- ▲ Applies easily
- ▲ Cleans up fast
- ▲ Temperature Range -65°F to +350°F

Available in size:

59ml (02 OZ) Bottle

TYPICAL APPLICATIONS

- ▲ Economical sealant for general assembly work
- ▲ Useful on paper, composition, felt and cardboard
- ▲ Hose connections
- ▲ Threaded connections

CPVC & UPVC BALL VALVE

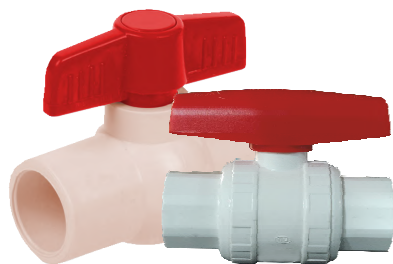

- ▲ Suitable for drinking water. International quality approval. For use with hot or cold water.
- ▲ Double EPDM O-rings. Teflon seats
- ▲ Light weight & quick assembly. simple & leak proof joints. Tough & rigid material.
- ▲ Fire resistance. Economical sealed unit



Available in size:
1/2", 3/4", 1", 1-1/2", 2", 2-1/2", 3", 4"

P.T.F.E. TAPE



- ▲ Acid & alkali resistant, insulation, soft & flexible
- ▲ Sealing & locking thread, used in pressurizing the screws of oil, water and air conduits

	Product Description	Teflon Tape
	Construction	
	Backing	P.T.F.E.
	Adhesive	N/A
	Colors	White, Yellow
Typical Physical Properties	Heat-resisting degree(°C)	370
	Cold-resisting degree(°C)	-190
	Able to bear the high pressure (kg/cm ²)	150-220
	Elongation (%)	>25
	Thickness (mm)	0.090, 0.10
	Length in Meter	10 Mtr, 12 Mtr
	Packing	1000 Pieces/Carton



GOLD 3600 Acetoxy Silicone Sealant

Gold acetoxy silicone sealant has multipurpose applications such as glazing, weather seal, sheet cladding, curtain walling, general sealing and assembling, drought proofing, sealing door & window frames, skylights, port lights, back lights etc. Automobile and wind shield glass fixing, HVAC & sanitary use.

Skin Over Time (min)	8-10	Tensile Strength (N/mm²)	1.0
Tack Free Time (min)	30	Elongation Approx %	700
Specific Gravity (g/cm³)	0.945-0.95	Yong's Modulus	0.22
Hardness (Shore A)	15-18	Service Temp (0C)	-20 to 180
Depth Cure (mm/day)	2-2.5	Shelf Life (Months)	12
Viscosity Flow (mm)	Non Sag	Available Size (ml)	280
Tooling Time (min)	20	Color:	Clear/White/Black/Cream/Gray



SILVER 3400 Acetoxy Silicone Sealant

Silver acetoxy silicone sealant are used for various applications such as glazing, general sealing and assembling, plumbing and sanitary, drought proofing, sealing door & window frames, port lights, back lights and air conditioning systems

Skin Over Time (min)	8	Tensile Strength (N/mm²)	0.80
Tack Free Time (min)	25	Elongation Approx %	500
Specific Gravity (g/cm³)	0.92-0.93	Yong's Modulus	0.20
Hardness (Shore A)	10-12	Service Temp (0C)	-20 to 120
Depth Cure (mm/day)	2-2.5	Shelf Life (Months)	12
Viscosity Flow (mm)	Non Sag	Available Size (ml)	280
Tooling Time (min)	15	Color:	Clear/White/Black/Cream/Gray



BRONZE 3200 Acetoxy Silicone Sealant

Bronze acetoxy silicone sealant are used for all application such as glazing, general sealing, sanitary and plumbing, drought proofing, windows and doors, air conditioning and many other DIY applications.

Skin Over Time (min)	7-8	Tensile Strength (N/mm²)	0.70
Tack Free Time (min)	20	Elongation Approx %	400
Specific Gravity (g/cm³)	0.91-0.92	Yong's Modulus	0.18
Hardness (Shore A)	8	Service Temp (0C)	-20 to 120
Depth Cure (mm/day)	2-2.5	Shelf Life (Months)	12
Viscosity Flow (mm)	Non Sag	Available Size (ml)	280
Tooling Time (min)	15	Color:	Clear/White



FAST 3700 Acetoxy Silicone Sealant

Fast acetoxy silicone sealant is a high grade sealant specially formulated for special applications such as industrial glazing, sheet cladding, assembling, automobile, water proofing, water exposed applications, auto glass, gasketing for sealing in stone, swimming pools.

Skin Over Time (min)	8	Tensile Strength (N/mm²)	1.1
Tack Free Time (min)	30	Elongation Approx %	800
Specific Gravity (g/cm³)	0.96	Yong's Modulus	0.22
Hardness (Shore A)	22	Service Temp (0C)	-30 to 180
Depth Cure (mm/day)	2	Shelf Life (Months)	12
Viscosity Flow (mm)	Non Sag	Available Size (ml)	280
Tooling Time (min)	20	Color:	Clear/White/Black/Gray



GLASS & AQUARIUM Silicone Sealant

Glass & Aquarium silicone sealant is a high grade sealant specially formulated for aquariums, glass cladding, glazing, auto wind shield fixing, industrial applications, back lights, port lights etc.

Skin Over Time (min)	7	Tensile Strength (N/mm²)	1.0
Tack Free Time (min)	12	Elongation Approx %	700
Specific Gravity (g/cm³)	1.02	Yong's Modulus	0.25
Hardness (Shore A)	25	Service Temp (0C)	-30 to 200
Depth Cure (mm/day)	2.4	Shelf Life (Months)	12
Viscosity Flow (mm)	Non Sag	Available Size (ml)	280
Tooling Time (min)	13	Color:	Clear/White/Black



W7800 Weather Sealant

Weather Sealant are commonly used for external weather sealing. Durable adhesion in range including concrete, masonry, brick, upvc, wood glass and glazed surfaces. Used in some metals for construction without danger of corrosion from the sealant.

Skin Over Time (min)	15	Tensile Strength (N/mm²)	0.9
Tack Free Time (min)	30	Elongation Approx %	800
Specific Gravity (g/cm³)	1.35	Yong's Modulus	0.3
Hardness (Shore A)	35	Service Temp (0C)	-40 to 200
Depth Cure (mm/day)	2	Shelf Life (Months)	12
Viscosity Flow (mm)	Non Sag	Available Size (ml)	280
Tooling Time (min)	10	Color:	Clear/White/Black/Cream/Gray/Brown



N7400 NEUTRAL Silicone Sealant

Neutral silicone sealant are used for interior and exterior applications like perimetral joints, building and other type of construction. Durable adhesion in range including concrete, masonry, brick, upvc, wood glass and glazed surfaces and some metals used in construction. Suitable for general applications.

Skin Over Time (min)	15	Tensile Strength (N/mm²)	1.0
Tack Free Time (min)	30	Elongation Approx %	550
Specific Gravity (g/cm³)	1	Yong's Modulus	0.22
Hardness (Shore A)	20	Service Temp (0C)	-20 to 200
Depth Cure (mm/day)	2.4	Shelf Life (Months)	12
Viscosity Flow (mm)	Non Sag	Available Size (ml)	280
Tooling Time (min)	13	Color:	Clear/White/Black/Cream/Gray



ACRYLIC Sealant

Acrylic sealant are used in the building industry for filling joints between wood, metal window frames, upvc doors & windows, concrete brick work, joints between concrete and ceiling elements, between wall and ceiling skirting boards, window sills, sealing around pipe joints, sealing duct work, wall cracks filling, aerated concrete for inside and outside applications.

Skin Over Time (min)	8	Service Temp (0C)	-40 to 150
Tack Free Time (min)	15	Shelf Life (Months)	12
Specific Gravity (g/cm³)	1.65	Available Size (ml)	280
Hardness (Shore A)	38	Color:	Clear/White
Depth Cure (mm/day)	1		
Viscosity Flow (mm)	Non Sag		
Tooling Time (min)	5		



SF-REGULAR Contact Adhesive

SF-REGULAR is synthetic rubber based brushable adhesive that provides excellent spreadability, long open time, high tack, high bond strength, suitable for most substrates as well as it's economical in the long run. The product can be used for bonding mattresses, sofas and chairs, wooden crafts as well as AC ducting.

Physical State	Liquid	Bondable Open Time	18 to 30 minutes
Odour	Typical Sweet	Tack Retention Time	2 to 30 minutes
Color	Light Tan	Adhesiveness	Over 2000 gf/25 mm
Density	0.84 \pm 0.02 Gms/ml	Coverage	3-5 sq.mtr./per litre
Flash Point	< 0°C		
Solubility in Water	Insoluble		

Available in size: 100ml, 200ml, 500ml, 1litre, 5litre, 15litre, 30litre



SF-222 Contact Adhesive

SF-222 is synthetic rubber based brushable adhesive which spreads easily, provides excellent coverage, high bonding strength and offers superior sticking power. The product is versatile and bonds most materials like foam and fabric, seat covers. It is heat resistant and flexible once cured.

Physical State	Liquid	Bondable Open Time	18 to 30 minutes
Odour	Typical Sweet	Tack Retention Time	2 to 30 minutes
Color	Light Tan	Adhesiveness	Over 2000 gf/25 mm
Density	0.84 \pm 0.02 Gms/ml	Coverage	3-5 sq.mtr./per litre
Flash Point	< 0°C		
Solubility in Water	Insoluble		

Available in size: 100ml, 200ml, 500ml, 1litre, 5litre, 15litre, 30litre



SF-333 Contact Adhesive

SF-333 is synthetic rubber based brushable adhesive provide ease in spreadability, excellent coverage, high bonding strength. The product is recommended for bonding a wide variety of materials e.g. wood, laminates, wooden crafts, rubber, cork, felt, foams, AC ducting, PVC, etc. to absorbent and non-absorbent substrates.

Physical State	Liquid	Bondable Open Time	18 to 30 minutes
Odour	Typical Sweet	Tack Retention Time	2 to 30 minutes
Color	Light Tan	Adhesiveness	Over 2000 gf/25 mm
Density	0.85 \pm 0.02 Gms/ml	Coverage	3-5 sq.mtr./per litre
Flash Point	< 0°C		
Solubility in Water	Insoluble		

Available in size: 100ml, 200ml, 500ml, 1litre, 5litre, 15litre, 30litre



SF-555 Contact Adhesive

SF-555 is brushable grade synthetic rubber based contact adhesive which offers high coverage, high adhesion, ready to use, resistant to the effect of water. The product is ideally used for applications such as bonding of luggage and trolley bags, sole, casual shoes, safety shoes, mattresses, sofas, chairs, seat covers.

Physical State	Liquid	Bondable Open Time	18 to 30 minutes
Odour	Typical Sweet	Tack Retention Time	2 to 30 minutes
Color	Light Tan	Adhesiveness	Over 2000 gf/25 mm
Density	0.83 \pm 0.02 Gms/ml	Coverage	3-5 sq.mtr./per litre
Flash Point	< 0°C		
Solubility in Water	Insoluble		

Available in size: 100ml, 200ml, 500ml, 1litre, 5litre, 15litre, 30litre



SF-777 Contact Adhesive

SF-777 is brushable grade ready to use synthetic rubber based contact adhesive providing high coverage, high adhesion and is resistant to the effect of water. The product is ideally used for the bonding of seat cover, mattress, sofas and chairs.

Physical State	Liquid	Bondable Open Time	18 to 30 minutes
Odour	Typical Sweet	Tack Retention Time	2 to 30 minutes
Color	Light Brown	Adhesiveness	Over 2000 gf/25 mm
Density	0.86 ± 0.02 Gms/ml	Coverage	3-5 sq.mtr./per litre
Flash Point	< 0°C		
Solubility in Water	Insoluble		

Available in size: 100ml, 200ml, 500ml, 1litre, 5litre, 15litre, 30litre



SF-888 Contact Adhesive

SF-888 is synthetic rubber based contact adhesive which is widely used to make furniture, footwear, luggage, duct insulation where the early setting is required. It has water-resistant properties which enable to deliver high coverage with high adhesion.

Physical State	Liquid	Bondable Open Time	18 to 30 minutes
Odour	Typical Sweet	Tack Retention Time	2 to 30 minutes
Color	Light Brown	Adhesiveness	Over 2000 gf/25 mm
Density	0.85 ± 0.02 Gms/ml	Coverage	3-5 sq.mtr./per litre
Flash Point	< 0°C		
Solubility in Water	Insoluble		

Available in size: 100ml, 200ml, 500ml, 1litre, 5litre, 15litre, 30litre



SF-999 Contact Adhesive

SF-999 is synthetic rubber based contact adhesive meant for excellent coverage. The product is ideally used for bonding AC ducts, wooden crafts, PVC flooring & furniture. It has high bonding strength with fast-drying and good tack properties.

Physical State	Liquid	Bondable Open Time	18 to 30 minutes
Odour	Typical Sweet	Tack Retention Time	2 to 30 minutes
Color	Light Brown	Adhesiveness	Over 2000 gf/25 mm
Density	0.83 ± 0.02 Gms/ml	Coverage	3-5 sq.mtr./per litre
Flash Point	< 0°C		
Solubility in Water	Insoluble		

Available in size: 100ml, 200ml, 500ml, 1litre, 5litre, 15litre, 30litre



SF-HEAT O PRO Contact Adhesive

SF-HEAT O PRO is a multipurpose fast bonding brushable grade synthetic rubber based contact adhesive having high heat resistant, high bond strength, long open time, spreads easily, suitable for most substrates. The product is used for bonding in various industries like furniture, footwear, handicrafts and automotive.

Physical State	Liquid	Bondable Open Time	18 to 30 minutes
Odour	Typical Sweet	Tack Retention Time	2 to 30 minutes
Color	Light Tan	Adhesiveness	Over 2000 gf/25 mm
Density	0.85 ± 0.02 Gms/ml	Coverage	3-5 sq.mtr./per litre
Flash Point	< 0°C		
Solubility in Water	Insoluble		

Available in size: 100ml, 200ml, 500ml, 1litre, 5litre, 15litre, 30litre

SP-604 Contact Adhesive



SP-604 is a synthetic rubber based sprayable adhesive which is ideally used for bonding of Foam to Foam and Foam to Fabric in furniture which are exposed to low wear & tear. This product is versatile making it favorites with upholsters work. It provides excellent Initial bonding, low viscosity, high strength and spreads easily.

Physical State	Liquid
Odour	Typical Sweet
Color	Light Tan
Density	0.80 \pm 0.02 Gms/ml
Flash Point	< 0°C
Solubility in Water	Insoluble

Bondable Open Time	18 to 30 minutes
Tack Retention Time	2 to 30 minutes
Adhesiveness	Over 2000 gf/25 mm
Coverage	80 to 100 gms /mtr ²

Available in size: 15litre, 30litre

SP-605 Contact Adhesive



SP-605 is synthetic rubber based sprayable multi-purpose adhesive. The product is ideally used in the automobile sector for bonding of PVC and carpet flooring, ply to felt and felt to Eva. The product has low viscous, high strength, instant bonding properties which provide higher coverage.

Physical State	Liquid
Odour	Typical Sweet
Color	Light Tan
Density	0.80 \pm 0.02 Gms/ml
Flash Point	< 0°C
Solubility in Water	Insoluble

Bondable Open Time	18 to 30 minutes
Tack Retention Time	2 to 30 minutes
Adhesiveness	Over 2000 gf/25 mm
Coverage	80 to 100 gms /mtr ²

Available in size: 15litre, 30litre

SP-607 Contact Adhesive



SP-607 is a high-performance synthetic rubber based sprayable adhesive specially designed for instant bonding of foam to foam applications foam to bonded foam, rexine, fabric to foam/ rexine, leather to leather/ foam or rexine, metal to foam, Foam to EPE sheet having low viscosity high strength properties It can also be used for vinyl flooring and carpet laying application. It is heat resistant and flexible once cured.

Physical State	Liquid
Odour	Typical Sweet
Color	Light Tan
Density	0.82 \pm 0.02 Gms/ml
Flash Point	< 0°C
Solubility in Water	Insoluble

Bondable Open Time	18 to 30 minutes
Tack Retention Time	2 to 30 minutes
Adhesiveness	Over 2000 gf/25 mm
Coverage	80 to 100 gms /mtr ²

Available in size: 15litre, 30litre

SP-BM Contact Adhesive



SP-BM is a synthetic rubber based sprayable high strength, high viscosity cross-linking adhesive which is ideally used by automobile industries for applications in a variety of substrates like bonding of high-density foam, thermal insulation, non-woven, plastics, plywood and timber log. The product is non-toxic in nature as it benzene free it can be used by spray or brush

Physical State	Liquid
Odour	Typical Sweet
Color	Light Tan
Density	0.81 \pm 0.02 Gms/ml
Flash Point	< 0°C
Solubility in Water	Insoluble

Bondable Open Time	15 to 30 minutes
Tack Retention Time	2 to 30 minutes
Adhesiveness	Over 2000 gf/25 mm
Coverage	70 to 100 gms /mtr ²

Available in size: 15litre, 30litre



POWER-SH Synthetic Resin Adhesive

POWER-SH is a PVA based specially modified cross-linked adhesive. It provides excellent adhesion to laminate/wood/veneer/particle board/block board to wood/ply/flush door/MDF/HDF. It also offers very high interior water-resistivity and good bonding in lamination with all grades of wood after optimum curing. POWER-SH has transparent, glossy, water resistance film properties having excellent coverage, providing powerful strength & using anti termite formula for termite treatment.

Available in size:
500g, 1kg, 2kg, 5kg, 10kg, 20kg, 50kg

Appearance	White VIS LIQ.
Color	White
Viscosity	250-300 poise
PH Value	4.5-6.5
Density	1.00-1.1
Solubility in Water	> 1:20



GOLD Synthetic Resin Adhesive

GOLD is synthetic resin based adhesive having transparent and glossy film properties. It is non flammable and non toxic in nature. These are used by furniture manufacturer, OEM for industrial usage as general purpose wood working applications having more coverage area and providing better strength while joining laminates to particle boards, decorative laminates, wood to wood & ply to wood

Available in size:
500g, 1kg, 2kg, 5kg, 10kg, 20kg, 50kg
** 1kg pouch is also available

Appearance	White VIS LIQ.
Color	White
Viscosity	250-300 poise
PH Value	4.0-6.0
Density	1.00-1.1
Solubility in Water	> 1:20



AQUA Waterproof Adhesive

AQUA is a PVA based specially modified copolymer for marine plywood. It provides excellent adhesion to laminate/wood/veneer/block board to wood/ply/MDF/HDF. It also offers very high exterior water-resistivity and excellent bonding in lamination with all grades of wood after optimum curing. AQUA is a waterproof adhesive which shows excellent cohesive strength at elevated temperatures, versatile balance that renders adhesive with good heat & fungal resistance. The film properties are water resistance, transparent & glossy in nature.

Available in size:
500g, 1kg, 2kg, 5kg, 10kg, 20kg, 50kg

Appearance	White VIS LIQ.
Color	White
Viscosity	250-300 poise
PH Value	4.0-6.0
Density	1.00-1.1
Solubility in Water	> 1:20



Qua D3 Synthetic Resin Adhesive

Qua D3 is a fast setting specially modified copolymer. It provides excellent adhesion to laminate/wood/veneer/block board to wood/ply/flush door/MDF/HDF. It also offers hot water-resistance and excellent bonding in lamination with all grades of wood after optimum curing. Qua D3 is a fast drying adhesive having waterproof properties with anti termite formula for termite treatment providing power strength while joining wood application with 2 -3 hours handling strength. The film properties are water resistance, transparent & glossy in nature.

Available in size:
500g, 1kg, 2kg, 5kg, 10kg, 20kg, 50kg

Appearance	White VIS LIQ.
Color	White
Viscosity	150-200 poise
PH Value	3.5-5.5
Density	1.00-1.1
Solubility in Water	> 1:20

What is FRP ?

FIBRE-REINFORCED POLYMER (FRP)

Is a composite material made of a polymer matrix reinforced with fibers. The fibers are usually glass fibers, the polymer is usually an epoxy, vinylester or polyester thermosetting plastic, and phenol formaldehyde resins are still in use. FRP's are commonly used in the aerospace, automotive, marine, construction industries and ballistic armor.

ADVANTAGES

HIGH LOAD RATING AND STRENGTH: Similar hardness in property as cast iron, but major advantages on stretch recovery and bend resistance. Less noise and lower vibration transmissions. Designed to meet and exceed A 15/ B125/ C250/ D400/ E600/ F900 loading rating, according to EN 124: 1994.

AGAINST THEFT AND SAFETY OPTIONS: Comparing with cast iron manhole cover, composite cover has zero theft value and therefore not attractive to thieves, which reduce the potential accident and further maintenance cost caused by theft. Anti skid surface that guarantees safe road condition even in extreme weather. Locking arrangement are available as an option molded into the cover. Non-electricity conduction and non-heat conduction, UV resistance.

EASE IN INSTALLATION: Compared with cast iron manhole covers, composited covers are 30% lighter. Lighter weight allows ease of handling, more loading per vehicle and more convenient transportation. This allows for safe working conditions, where a SINGLE worker is enough for a complete installation without risk of injury. Easy handling and movement reduce maintenance cost.

DURABLE SERVICE LIFE: More than 30 years of theoretical service life under ideal road condition. Anti-corrosion, dust and waterproof, well sealed prevent poisonous gases from leaking out. Higher and lower temperature tolerance.

FREE DESIGN: Composite material itself allows for innovative design features. Client logo and their own design are available as an option. Much more clear resolution ratio design than cast iron or of other material.

CARBON FOOTPRINT SAVING AND ENVIRONMENTAL CARE: Lower embedded energy carbon emission during manufacturing process than cast iron covers. New material, manufacturing technology and lean production help reduce carbon footprint.

INSTALLATION

Do's

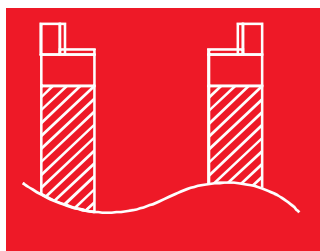

Correct installation of frame with complete civil support

Don't



Incorrect installation of frame without any civil support below

HANDLING

Do's



Handle with care

Don't



Do not throw the material

FRP MANHOLE COVER

STRONG DRAIN™

Circular Manhole Cover



Sizes: Dia 530, Dia 600, Dia 690,
Dia 720, Dia 900

Load Capacity: 2.5, 5, 12.5, 25, 40

Square Manhole Cover

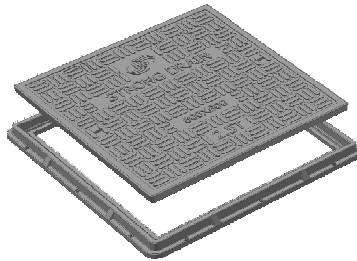

Sizes: 300x300, 450x450, 600x600,
750x750, 900x900, 1000x1000,
1200x1200

Load Capacity: 2.5, 5, 12.5, 25, 40

Rectangular Manhole Cover

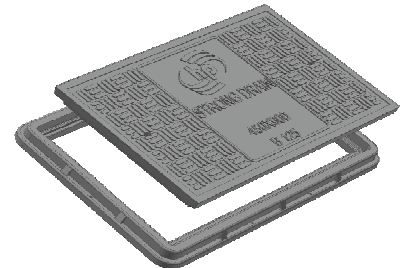

Sizes: 450x600, 450x900, 600x900,
900x1200

Load Capacity: 2.5, 5, 12.5, 25, 40

Water Gully Cover

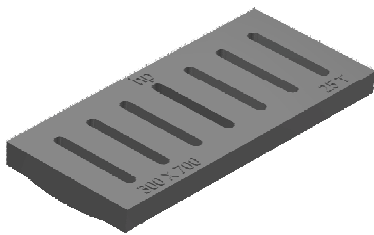

Sizes: 450x450, 500x600, 600x600,
600x900, 900x900, 750x750,
240x640, 300x620

Load Capacity: 2.5, 5, 12.5, 25, 40

Over Head Tank Cover

* MCGM Approved



Sizes: 600x600, Dia 600, Dia 450

Load Capacity: 0.5

Under Ground Tank Cover

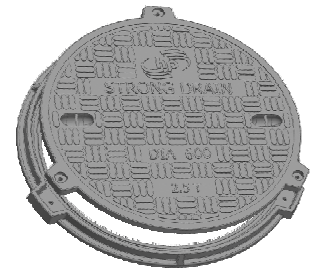

Sizes: Dia 600

Load Capacity: 2.5, 5, 12.5, 25, 40

Recessed Cover

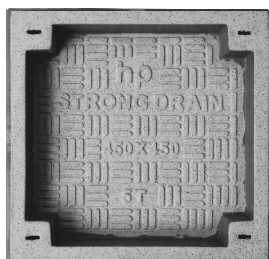

Sizes: 300x300, 450x450, 600x600,
450x900, 600x900, 1000x1000

Load Capacity: 2.5, 5, 12.5, 25, 40

Grating & Chequer Plate

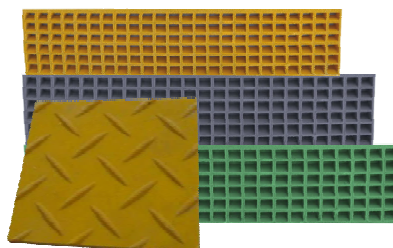

Sizes: 15 mm, 30 mm & 40 mm

Tree Grating



Sizes: 1200x1200, Dia 880

*All Load Capacity in Metric Ton

*All Sizes in Millimeters



HP ADHESIVES PVT. LTD.

11, Unique House, Chakala, Andheri (E),
Mumbai - 400099. Maharashtra, India.

Ph: +91-22-68196300

Visit us @ www.hpint.in

Email: info@hpint